

CAL 27

JENSEN MARINE

27

CAL 27—new, convertible h



The Cal 27 is the newest ocean racer-cruiser from the famous team of Jensen / Lapworth, and offers an unusual combination of features—a fast high-performance hull, with full cruising accommodations, at an economical, affordable price.

In addition to the famous Cal-fast features of light displacement and long waterline, the Cal 27 has a brand new underbody design with a short, swept back keel and a ventral fin/spade rudder. This combination gives the Cal 27 excellent windward capability and positive off-the-wind tracking. With its built-in speed, the Cal 27 is becoming one of the most consistent winners in the Cal fleet.

The Cal 27 has comfortable cruising accommodations for 5 or 6 in two separate cabins, a fully enclosed head, and room you would expect on a much larger boat. She's powered by an outboard motor. Inboard power will be available soon.

Spacious, airy two-cabin interior:

The spacious two-cabin interior of the Cal 27 is fully equipped for serious racing or leisurely cruising. An exceptionally large vinyl covered settee



atch racer-cruiser from Jensen/Lapworth.



in the main cabin encircles a folding dinette table and converts into a double berth. The starboard side galley includes a countertop and a stainless steel sink and 12 gal. water tank, a large icebox, and two burner stove space.

The head and hanging locker in the forward section close off from the main and forward cabins for privacy. The forward compartment sleeps two on a large double berth.

Unique, convertible headroom hatch:

Bill Lapworth gave the Cal 27 a pleasing trunk cabin profile and full headroom with a

unique, convertible hatch.

At anchor or dockside, the entire 5' x 6½' fiberglass hatch raises 14 inches for a full 6½ feet of headroom in the main cabin. An optional canvas cover encloses the opening from the weather. In its normal or down position, there is a full 5 feet of sitting headroom below.

High aspect sailplan:

To give the Cal 27 plenty of "go" power, Bill Lapworth designed the high aspect sailplan with an unusually large foretriangle. This offers a large choice of headsails for maximum speed in almost any wind condition.

Large self-bailing cockpit:

The Cal 27's large self-bailing cockpit is carefully laid out for efficient racing and comfortable cruising. The seats are set for optimum comfort and visibility. Two underseat stowage compartments with hinged fiberglass covers furnish additional storage room.

An "outboard transom" allows quick and easy installation of an outboard motor.

The Cal 27 comes fully equipped with running rigging, main and jib sheets and all blocks and shackles for working sails. Three racing winches are also included.

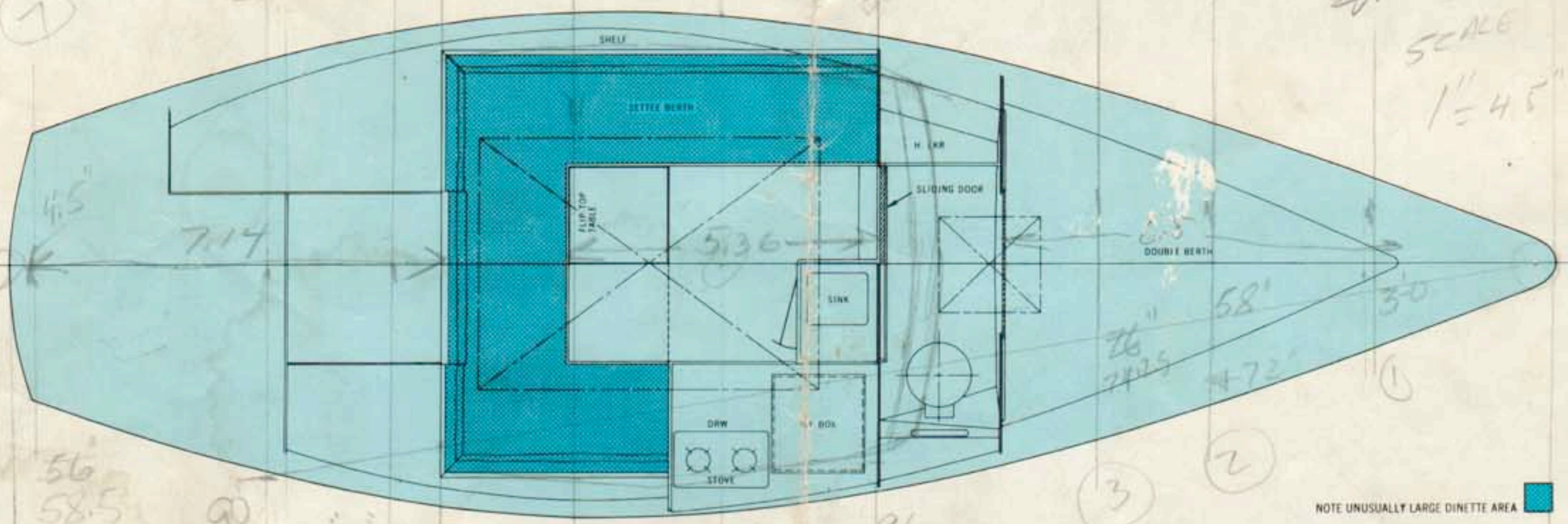

Cal 27 specifications:

STANDARD EQUIPMENT: Hull: One-piece reinforced fiberglass lamination made of hand laid up woven roving for extra impact strength. **Deck and cockpit:** Cabin, deck and cockpit integrally molded of fiberglass lamination with additional deck stiffening. Colors and non-skid surfaces molded in. **Cockpit:** Self-bailing and fully scuppered. Underseat storage with two hinged fiberglass hatches. **Ballast:** Lead 2500 lb. **Rigging:** High aspect masthead rig. Aluminum mast and boom. Standing rigging, including turnbuckles, chainplates and fittings, is stainless or bronze. Running rigging is dacron and stainless. **Winches:** Two #16 jib sheet racing winches and one #14 jib halyard winch. Genoa track, fairleads and mainsheet cleat. **Ventilation and ports:** Fiberglass 5' x 6½' raising main hatch, hinged forward hatch. Four fixed and two opening ports. **Interior:** Five permanent vinyl covered foam berths. Dinette converts to double berth. **Galley:** Starboard side galley with

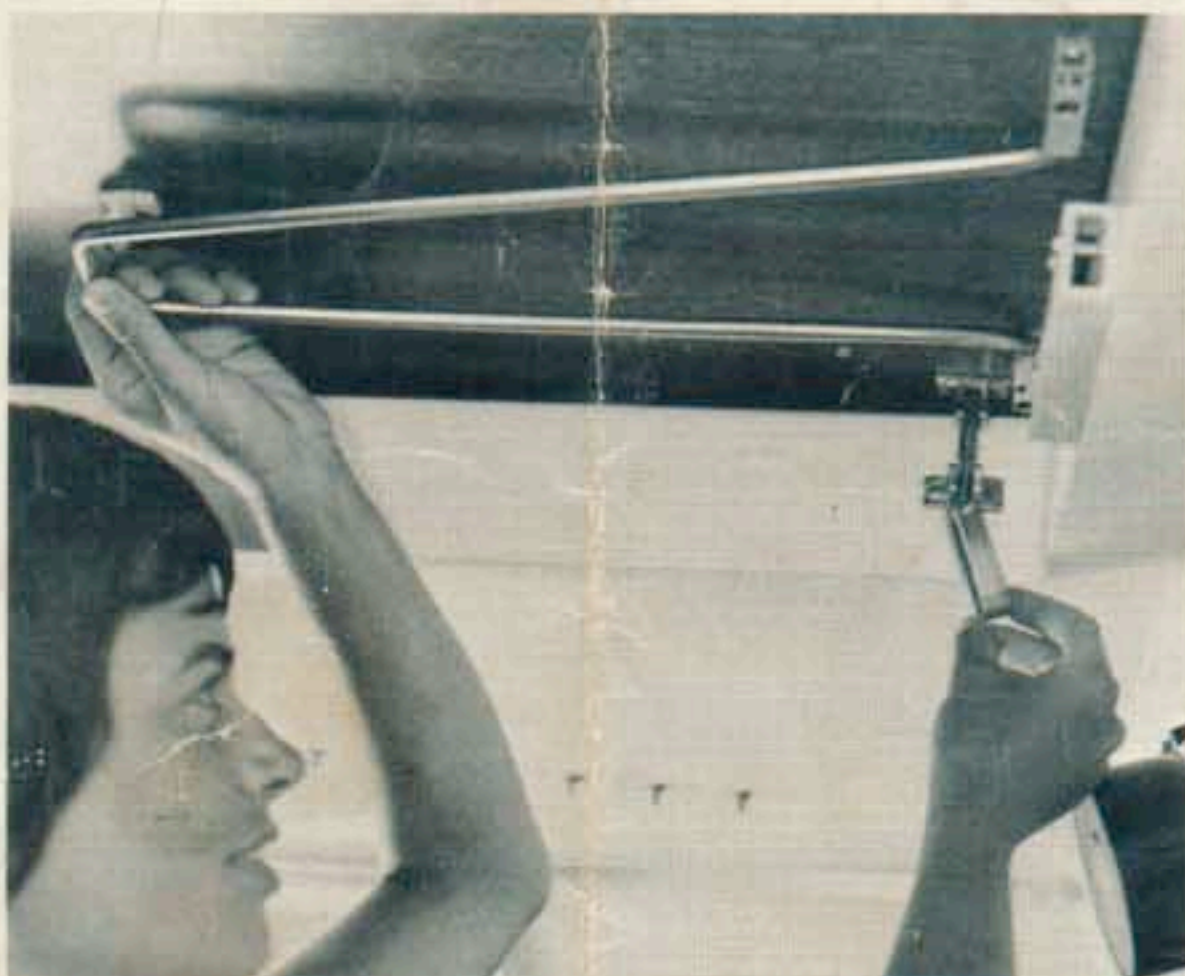

countertop, stainless sink with fresh water pump and 40 lb. ice-box. Four storage drawers and storage compartment. **Electrical:** International running lights on mast and hull and three interior lights with fuse panel, all 12 volts. **Auxiliary power:** Outboard transom standard, for medium size outboard motor.

OPTIONAL EQUIPMENT: A variety of optional equipment to suit individual needs is available for the Cal 27 from Jensen dealers. This includes pulpits, life lines, spinnaker gear, additional winches, spreader lights, and instrumentation.

ALL PRICES AND SPECIFICATIONS ARE SUBJECT TO CHANGE AT ANY TIME, INCLUDING AFTER RECEIPT OF THE CUSTOMER'S ORDER, UNTIL FINAL DELIVERY TO THE CUSTOMER.

Dimensions:

L.O.A.	27'4½"
L.W.L.	22'4"
Beam	9'
Draft	4'6"
Sail Area	350 sq. ft.
Displacement	5400 lb.
Ballast	2500 lb.

P = 28'-8"
 E = 9'-7"
 I = 34'-0"
 J = 11'-10"
 L.P. = 20'-5"

BLUEWATER YACHT SALES, INC.
 P. O. Box 6146
 Portsmouth, Virginia 23703
 (703) 484-5127

Jensen Marine
 A DIVISION OF BANGOR PUNTA CORPORATION

235 FISCHER STREET, COSTA MESA, CALIF., 92627

BANGOR PUNTA'S WIDE WORLD OF BOATING™ DUO/JENSEN/ULHRS/O'DAY/SEAGOING/STARCRAFT/ULRICHSEN

20 | 21 | 24 | 25 | 29 | 30 | 34 | 37 | 40 | 43 | 36 | 46

7.25 = 2.0
 27.35 = X
 X = 2.0 x 2.0 = 7.5
 7.25